

Step 01- Fix Pressure Plate

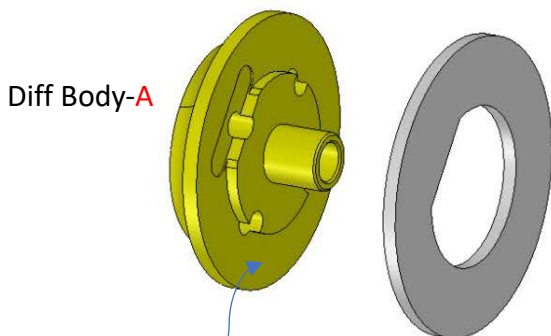

Steel Pressure Plate
For better result, polish the plates using fine sandpaper, #2000 or #3000

Apply Ball Diff Grease to the surface, as sticky agent to hold the pressure plate in place.

Step 02 – Diff Gear

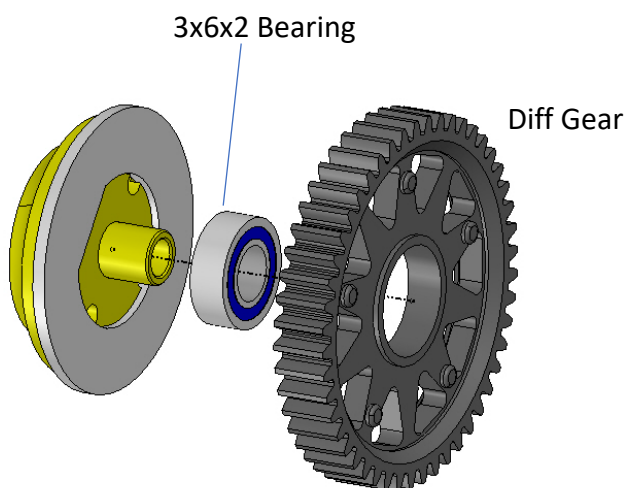

Step 03 – Diff Balls

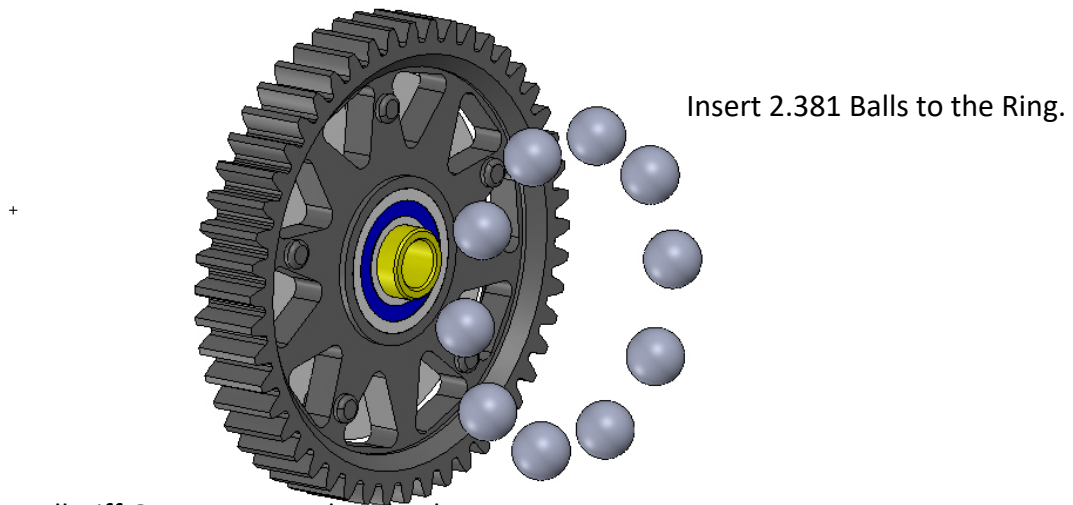

- 1- Apply Ball Diff Grease to your hand palm.
- 2- Then put all the balls on palm.
- 3- Rub the balls with finger to make sure the grease is evenly applied on each ball surface.
- 4- Put the balls in the gear ring.

Step 04 – Fix Pressure Plate

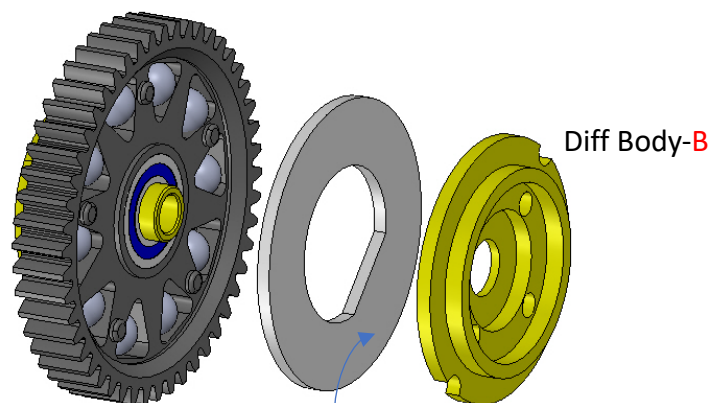

Apply Ball Diff Grease to the surface, as sticky agent to hold the pressure plate in place.

Step 05 – Thrust Bearing

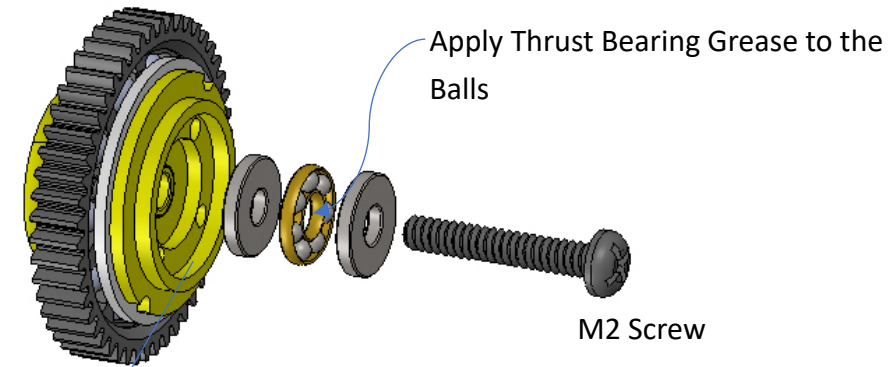

Note the orientation of the parts, Thrust Bearing must be fixed on the Diff Body - B.

Step 06 – Spring Washer

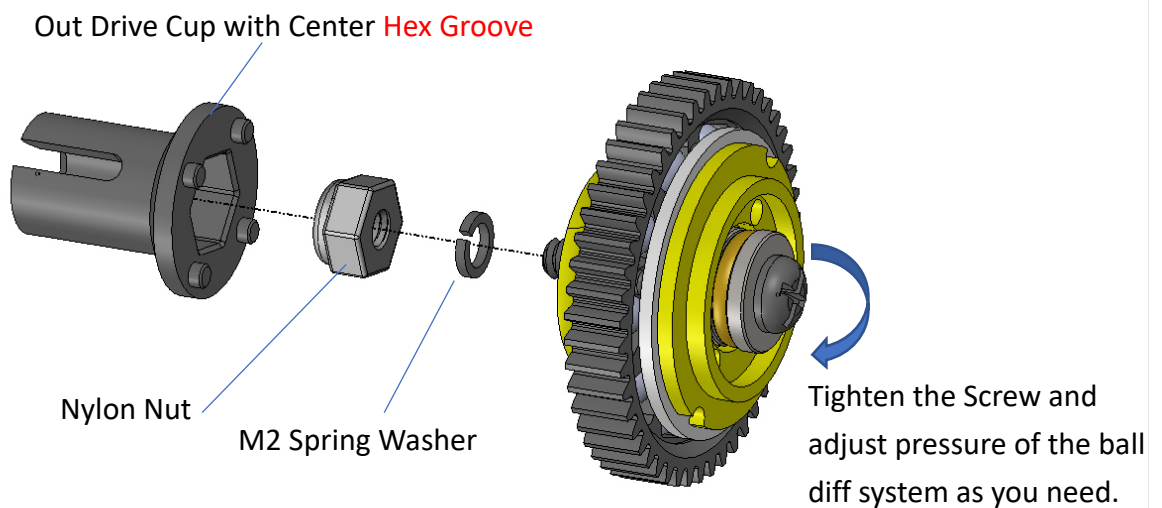

Step 07 – Fix Bearing

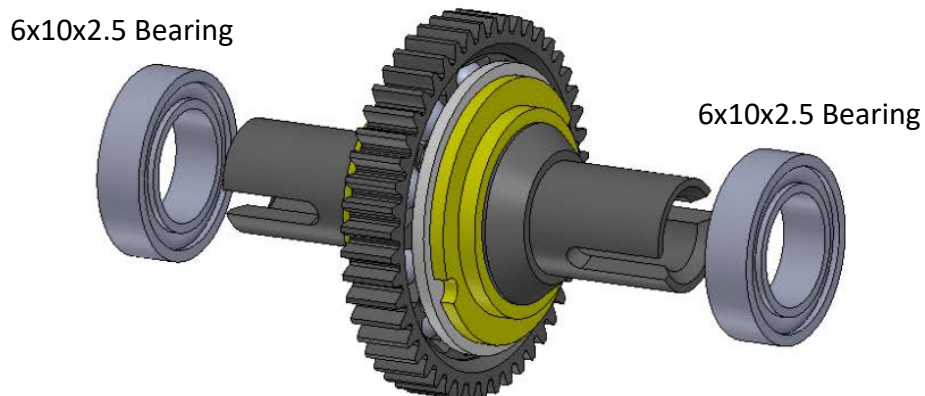

Must use the Bearing that come with the Ball Diff package (6 x 10 x 2.5), which is thinner than the stock bearing that come with the car kit

Step 08 – Finished

